

- Clean before first and each use.
- Before first use place all components separately in boiling water for 5 minutes. This is to ensure hygiene.
- Inspect all components before each use and throw away at the first signs of damage or weakness.
- To ensure proper cleaning/sterilizing all bottle parts **MUST** be disassembled.
- Cleaning/sterilizing while assembled can damage the bottle.
- Dishwasher safe on top dishwasher rack (max. 149° F / 65° C). Food coloring may discolor components.
- Do not use abrasive cleaning agents. Only soft bristle brushes or soft sponges should be used. Hard scourers may scratch the plastic.
- Sterilize using one of the following methods: steam sterilizing (electric or microwave according to manufacturers' instructions), boiling in water for at least 5 minutes or liquid sterilizing solution.
- Do not leave single bottle parts in direct sunlight or heat, or leave in sterilizing solution for longer than recommended, as this may affect the product function.
- The bottle is made of polypropylene which is hygienic, easy to clean and relatively soft. Avoid any heavy pressure on it, as this could affect the function.
- Do not use pins or sharp objects to enlarge feeding hole.
- Avoid giving foods or liquids containing sugar to the child.
- When first used and sometimes for later usages, the slit in the ventilation (the raised, slit bubble on the underside of the nipple base) can stick together, therefore not allowing air to enter the bottle during feeding and result in the nipple collapsing. Slowly brush over the bubble (ventilation) a few times with your thumb or fingers to re-open the slit.
- To avoid injury, do not let baby walk with bottle.
- Do not let a child take a bottle to bed or self-feed for a long period.
- Prolonged contact with sweet liquids may cause severe tooth decay.
- Store nipples and vent in a dry, covered container.
- Do not prop bottle to feed.
- Always use only MAM soft silicone nipple with the MAM bottles.

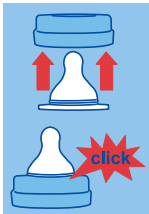

Insert nipple into top of bottle
screw ring until you hear a "click".

HEATING INSTRUCTIONS:

- NEVER pour boiling water into the bottle.
- NEVER heat or cool a sealed bottle. Remove the protective cap and nipple before heating. Microwave heating is not recommended.
- Do not overheat.
- Place in bottle warmer, under hot running water or in a container of heated water.

▲ **WARNING- For your child's safety and health!**

- Always use this product with adult supervision.
- Never use feeding nipples as a pacifier.
- Continuous and prolonged sucking of fluids will cause tooth decay.
- Always check food temperature before feeding.
- Keep all components not in use out of the reach of children.
- Wash all parts prior to use. Do not let a child take a bottle to bed or self-feed for long periods.
- To prevent possible choking hazard, test strength of nipple by pulling on bulb portion. Discontinue use if any tear or crack appears.
- Wrap cloth or towel around bottom of bottle and shake to absorb any excess water after warming in a bottle warmer or boiling water.