

MICROWAVE STEAM STERILIZER

- Designed especially for MAM products. Suitable for the disinfection of all bottles, nipples and other baby products according to the manufacturer's instructions.
- Holds up to 6 bottles with components. For microwave and cold water disinfection.
- Use only for microwavable products. All MAM bottle and cup components are suitable for microwave disinfection.
- The closed appliance with water is placed in the microwave. Microwaves allow the water to vaporize. The hot steam sterilizes the products and components in the appliance.

MAM sets new standards for cleanliness and safety

The MAM Microwave Sterilizer has been subjected to the strictest testing criteria. In doing so, MAM sets new standards of cleanliness and safety. The minimum disinfection time of 5 minutes is based on the test results. Disinfection time can usually be reduced by washing articles prior to sterilizing. MAM products are specially suited for these intensive sterilizing times.

Microwave Steam Sterilizer Usage:

- 1) Carefully wash all items (soothers, bottles etc.) and components in mild soapy water and then rinse with clean water.
- 2) Open the latch on the microwave steam sterilizer. Remove the lid. Take the upper and lower baskets out as necessary.
- 3) Fill exactly 200ml / 7 UK fl. oz. into the base of the microwave steam sterilizer. The use of a measuring cup is recommended. Please pay attention to the measure marking inside the base! Ensure an exact measure of water.
- 4) For disinfection disassemble the products to their individual components. MAM Anti-Colic bottles must be completely disassembled; the base ventilation must be taken out of the screw base for disinfection. Sterilizing assembled components can damage the bottle.
- 5) Place the bottles and components in the microwave steam sterilizer. In the MAM Microwave Steam Sterilizer the products can be flexibly arranged on 2 levels and the sterilizer holds up to:
 - 6 MAM Anti-Colic 5 oz bottles or
 - 4 MAM Anti-Colic 9 oz bottles or
 - 5 MAM Easy Active 11 oz Baby Bottles or
 - 6 MAM Easy Active 9 oz Baby Bottles

incl. additional products like pacifiers.

- 6) With the products inside, replace the lid and close the latch. The lid must "click" into place.
- 7) Place the appliance in the microwave. Should the appliance not fit into the microwave, please check that the lid has "clicked" into place correctly.
- 8) The appliance is suitable for microwaves with wattage 850 to 1850. The disinfection times correspond to the microwave's wattage; adhere to the given times.
- 9) Allow microwave steam sterilizer to cool down before removing from microwave. Recommended cooling time: 3 minutes at opened microwave door. Hold the sterilizer straight when removing.
- 10) CAUTION when opening the sterilizer after use. Hot water vapor can escape and the remaining water may be very hot - SCALDING HAZARD.
- 11) Residual water in the products can be removed with the draining function in the lid. On the inside of the lid there are drainage grooves. Products can be placed on the inside of the upturned lid individually or with the baskets.
- 12) Use the tongs to remove and assemble the components.
- 13) Pour any water from inside the sterilizer away and dry with a soft cloth.
- 14) After the disinfection process, products stay disinfected for up to 24 hours in a closed appliance.

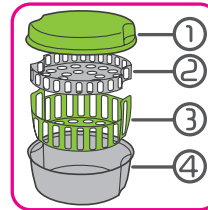

- 1 lid
- 2 upper basket
- 3 lower basket
- 4 base

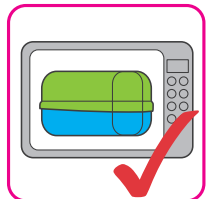
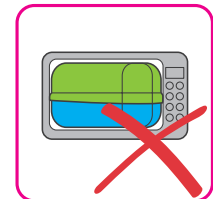
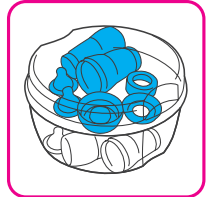

Wattage	Time*	Cooling time
850 W – 1800 W:	6 min	3 min
1850 W:	5 min	3 min

*max. power

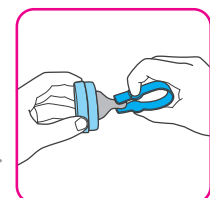
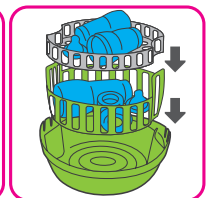
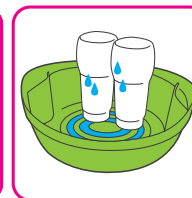

Continued
on page 2

Cold water disinfection usage:

- 1) Carefully wash the bottles and components in mild soapy water and then rinse with clear water.
- 2) Various commercially available anti-bacterial solutions or tablets can be used for cold water disinfection.
- 3) Always follow the manufacturer's instructions.
- 4) Fill the base of the microwave steam sterilizer with water. The measure of water and duration of disinfection depends on the instructions from the manufacturer of the solution or tablets and the number of products to be sterilized. All components must be fully immersed for disinfection.
- 5) Air bubbles in bottles compromise disinfection.
- 6) Disinfection solution must be regularly renewed according to the manufacturer's instructions.
- 7) Pour away any surplus disinfection solution.

**General Information**

- The microwave steam sterilizer should only be placed on solid, flat, dry and nonflammable surfaces.
- The microwave steam sterilizer is aligned to commercially available microwave appliances. There must be enough space between the microwave and sterilizer. The sterilizer must not touch the microwave walls. Do not force the sterilizer into the microwave. Sterilizing in too small a microwave can damage the sterilizer and the microwave.
- Do not sterilize metal or electronic parts. Watch out for non-sterilizable elements of composite products.
- Filling the sterilizer with inaccurate water measures can damage the sterilizer and the microwave. Too little water and the parts will not be properly sterilized. Too much water extends the disinfection time. Never place in the microwave without water.
- Do not use bleach.
- If using a combination microwave oven, ensure that the microwave steam sterilizer is not exposed to the heat of the grill because this could damage it.
- Attention when dealing with sterilized products since they may still be hot.
- Wash hands before using sterilized products.
- Please do not use abrasive cleaning agents. Please only use soft brushes or sponges. Hard objects can scratch the surface.
- Microwave steam sterilizer can be washed in the dishwasher.
- Only store the appliance dry.
- To avoid lime scale pour any surplus water away and dry the appliance with a soft cloth. Slight lime scale can be wiped away with a damp cloth. More stubborn lime scale can be removed with diluted household vinegar.
- To avoid stubborn lime scale and safeguard the sterilizer's proper function it is recommended that the sterilizer be regularly descaled, especially in regions with hard water.

▲ CAUTION - for your child's safety and health!

- Keep all components out of the reach of babies and children.
- Never place the appliance within the reach of children.

SOFT BRUSH - BOTTLE BRUSH

- The bottle brush is made from high quality materials: bristles and nipple brush: TPE; handle: PP.
- Clean before first use and at regular intervals thereafter.
- Inspect the bottle brush before each use.
- Discontinue use at the first signs of damage or weakness.
- To ensure hygiene rinse the bottle brush thoroughly after use and let it dry in a well-aired place.
- For disinfection wash with detergent and warm water.
- The bottle brush can be placed in a dishwasher (cutlery or top rack) at low temperatures (140° F / 60° C).
- Do not rest the bottle brush directly on the soft bristles in the dishwasher. Place the bottle brush in the cutlery or top rack, bristles up for dishwashing.
- Do not use aggressive cleaning agents.
- Food colorings may discolor the bottle brush.
- Do not boil, steam or microwave sterilize. Otherwise deformation of bristles can occur.
- Suitable for cleaning all bottles and nipples.
- The Soft Brush is also especially suitable for cleaning MAM Cups.